

Attachment brackets

For all excavators in the 1–33 tonne weight classes

- » Easy to modify buckets for Engcon hitches
- » Robust, reliable and value-for-money
- » Welded in high-strength steel

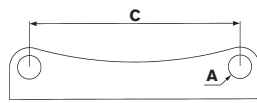
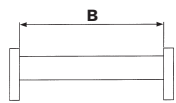

Specifications

Model	GS30/180	GS40/200	GS45	GS60	GS70	GS80
Axle diameter A: (mm)	30	40	45	60	70	80
Width B: (mm)	180	200	290	340	450	590
Length C: (mm)	230	300	430	480	600	670
Thickness: (mm)	10	12	20	30	30	30
Quick hitch standard:	S30	S40	S45	S60	S70	S80

CHANGE THE WORLD OF DIGGING